

LADIES AND GENTLEMEN!

Thank you for purchasing a device manufactured by our company. We hope that thanks to its advantages our device will serve you long and well. Please read this manual. The information contained here will help you use the product properly and will allow for long-lasting and reliable operation of the device.

Our devices have been produced in accordance with the safety standards and have the positive opinion of the National Institute of Hygiene.

TABLE OF CONTENTS

I. Product characteristics.....	page 3
II. Unloading.....	page 4
III. Preparation of the Device for Operation.....	page 6
IV. Operation.....	page 7
V. Maintenance.....	page 2

Before you call the service

In case of any difficulties during the startup or the operation of the device, please refer to the chapters of the manual which explain the performed operation. This is to ensure that the device is properly operated. If the difficulties persist, the following instructions will help in solving them.

The device is not working...- Make sure that:

The voltage and frequency in the mains are consistent with the recommendations of the manufacturer i.e. 230V and 50 Hz.

The device is connected to the power supply

The device switches on the control thermostat and the main switch are turned ON.

The device does not reach the proper temperature. Make sure that:

The switch of the cooling unit is turned ON

The temperature setting on the thermostat is set properly

Make sure the condenser is not contaminated, clean if necessary

The ambient temperature does not exceed 25°C.

In such ambient temperatures the manufacturer

does not guarantee the proper temperatures inside the device.

The device is working, sound signaling is activated ... -Make sure that:

The condenser is not contaminated, clean if necessary

The condenser fan is working

The ambient temperature does not exceed 25°C.

If the difficulties persist, please contact the local service of the Igloo company, indicating the serial number and the model of the device which are stated on the nameplate.

In order to ensure the minimal electricity consumption:

- do not place the device close to sources of heat
- ensure proper air circulation around the device
- avoid unnecessary opening of doors and leaving them open for longer periods of time.

V. Maintenance.

All maintenance activities should be carried out after the device is disconnected from the power supply.

1. Cleaning of the condenser:

Remove the cover and thoroughly clean the condenser using a vacuum cleaner, brush or compressed air.

(Fig. 1)

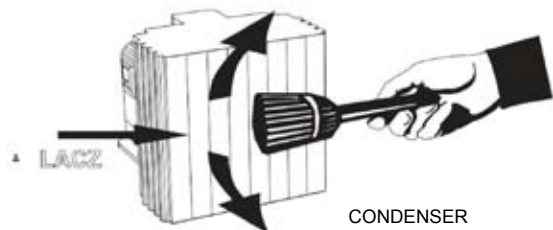

I. Product characteristics:

Cooling Chamber (assembled), designed for the cooling and storage of goods in containers at ambient temperatures from 10°C to 25°C and air humidity up to 60+ 5%.

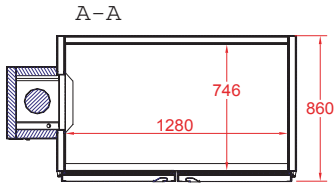
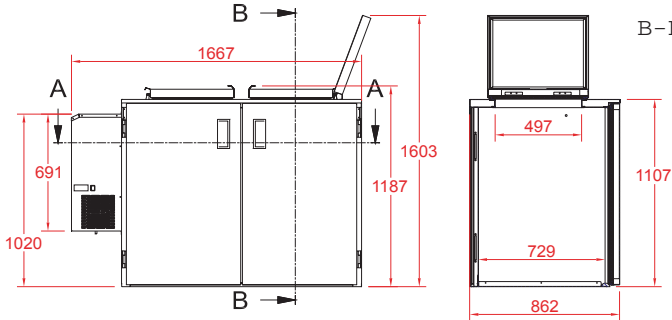

ODP

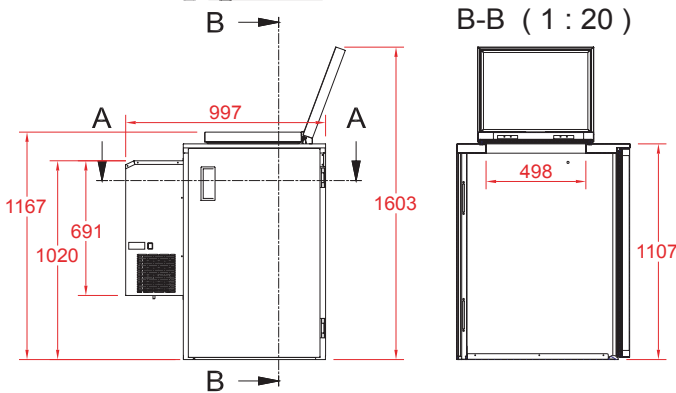

A-A (1 : 20)

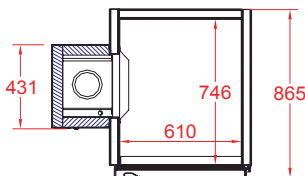

ODP 01

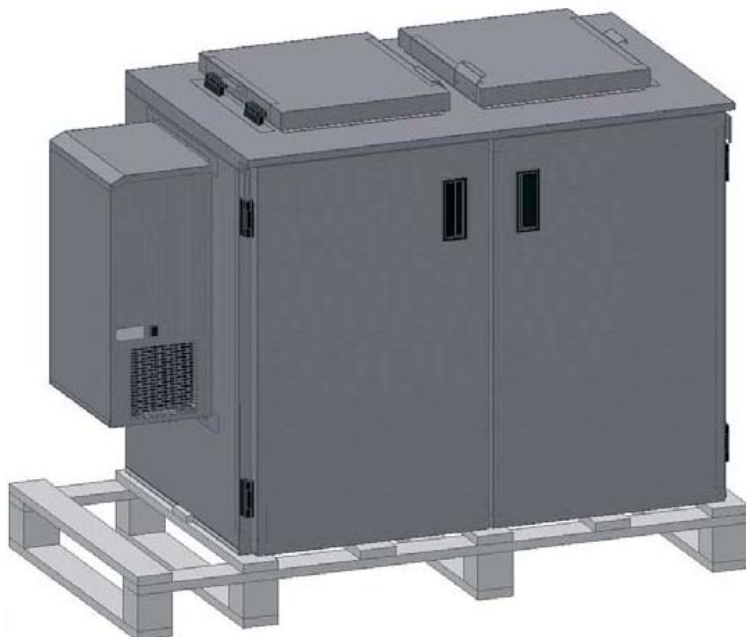
**General information:**

Our devices have been executed according to the latest technologies providing high durability and good operational parameters.

The temperature in the chamber stays in the range of +4 to + 8°C.

Equipment of the device:

When buying our devices you also receive

- an instruction manual
- a warranty card

II. Unloading

The chambers are supplied fully assembled on a special pallet.

The device on the pallet should be unloaded manually or using an appropriate lift (forklift, pallet-truck), always in the position of normal operation.

The maximum tilt angle is up to 15 degrees.

The operation of the device is controlled by a temperature regulator which is equipped with:

- **cooling unit switch** allowing for disabling the cooling unit at any time without disconnecting the power supply of the cooling device;
- manual defrosting button allowing for the activation of the defrosting cycle at any time during the operation of the cooling device (regardless of the automatic defrosting function); the button is not active when the temperature is higher than the final defrosting temperature.
- **temperature preview button** allowing for the preview of the temperature on the defrosting sensor or sensors and the condenser temperature sensor. In case the condenser temperature exceeds the permissible limit, the user is notified with a sound signal. In such a situation, please clean the condenser, check whether the condenser fan is working and whether the ambient temperature exceeds 25°C.
- **digital temperature display** allowing for the ongoing control of the temperature inside the cooling device

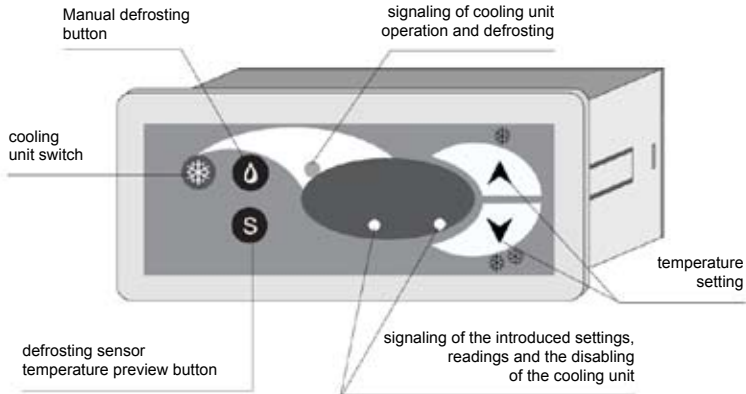

In order to ensure long-lasting and effective operation of the device, the user should comply with the following rules:

1. do not fill the device with goods before it cools down (about 1 ~2 hours from the time of activation)
2. do not put warm products into the cooling chambers
3. the goods should be distributed in such a way that the ventilation holes are not blocked
4. do not leave open covers and doors
5. clean the condenser at least once a month, or in the case of contamination The method of cleaning of the condenser is shown on page 10
6. wash the device with warm water with the addition of non-abrasive cleaning agents, after the device is unplugged from the power supply. It is prohibited to use corrosive agents as they can lead to the irreversible damage of the surface of the device.

In the everyday operation the top covers are used for the loading of the containers in the chamber (see fig.). In order to exchange the containers please open the door and unload the container.

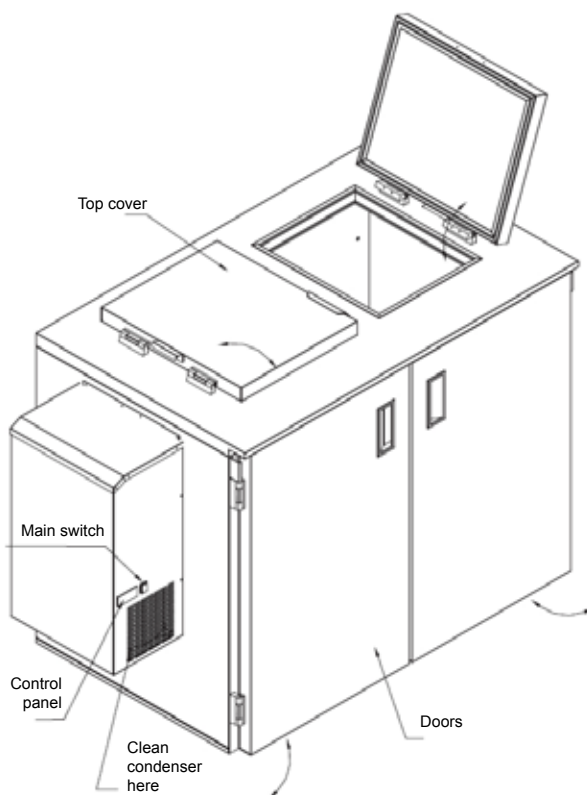

In order to set the chamber in the place of operation please cut off the protective bands, remove the foil from the chamber and remove the protective blocks on the pallet.

The chamber should then be unloaded from the pallet manually by four people (the straps with the handles mounted on the chamber serve this purpose). During unloading, use protective gloves (hand protection) and pay attention to the steady and even raising and lowering of the chamber.

After the chamber is set in the place of operation remove the straps used for unloading the chamber from the pallet.

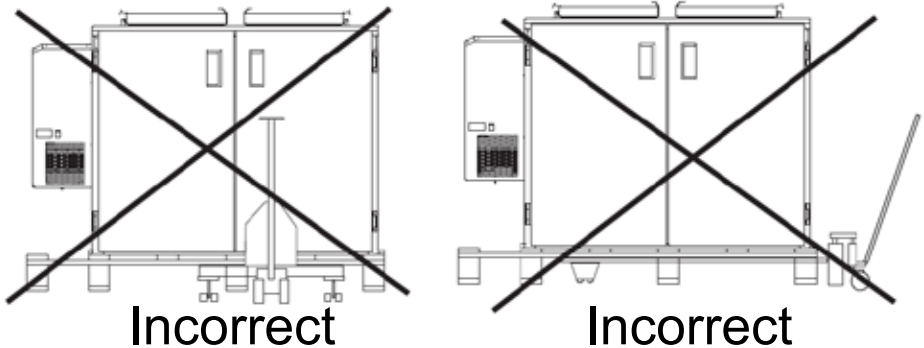
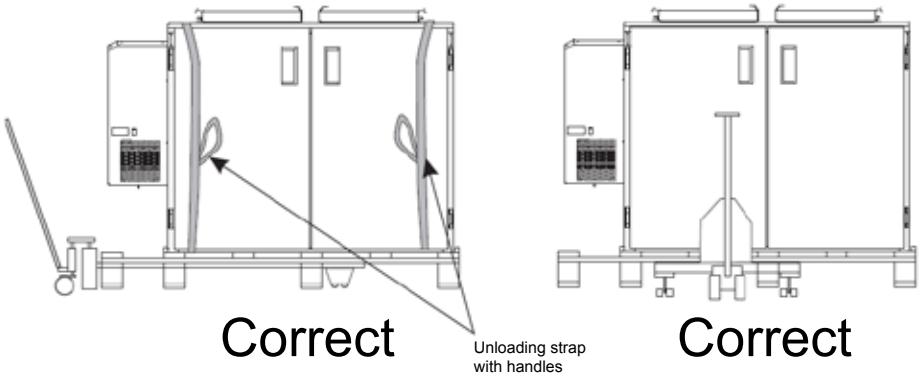

Transport of the device.

III. Preparation of the Device for Operation

The chambers can be installed in confined spaces where ventilation is provided, or under roofs (shelters) protecting the device against precipitation. If the device is installed in confined spaces the ventilation must ensure that temperatures within the room are no higher than 28°C. Consequently, the room should have ventilation holes located in such a way as to ensure the flow of fresh air throughout the room (we recommend the execution of a forced ventilation system by applying an exhaust fan).

The chamber should be set on concrete flooring or on a leveled surface protected against surface moisture absorption.

The device should be set in a dry place with a good air exchange, away from direct sunlight and from sources of heat (ovens, central heating systems, blow heaters).

The device should be connected to a separate, properly executed electric circuit (230 + 10% V/50 Hz with a two-pin power plug with a grounding pin). The socket should be protected with a fuse with a minimal value of 6.0 A, max. 16A.

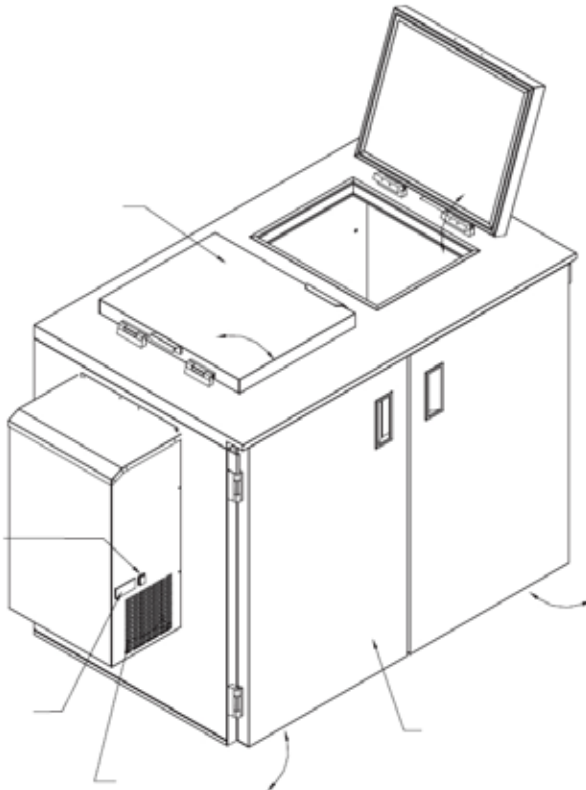

CAUTION: It is prohibited to connect the device via extension cables or dividers.

After the completion of these step, the device is ready to begin operation

IN THE CASE OF FAILURE TO COMPLY WITH THE THE RULES CONTAINED IN THIS MANUAL CONCERNING THE CONNECTION AND OPERATION OF THE DEVICE, THE MANUFACTURER RESERVES THE RIGHT TO WITHDRAW FROM THE OBLIGATIONS OF THE GUARANTOR!!!

IV. Operation

Startup of the device:

1. Insert the plug of the power cord in the socket
2. Turn the main power switch ON
3. Turn the cooling unit ON using the button located on the temperature regulator control panel (see illustration of the regulator)
4. Set the desired temperature in the range of 4-8°C using the buttons located on the temperature regulator control panel (see illustration of the regulator)